

DRY TYPE DIAPHRAGM PRESSURE GAUGE

MODEL : P770 SERIES

WISE®

SERVICE INTENDED

P770 Series is equipped with specially designed dry type diaphragm. This special diaphragm offers P770 a unique capability to use with all gases, liquid, high-viscosity fluids, solids entrained media, and even corrosive chemicals. Due to its high-performance, P770 is a perfect solution for a wide range of process industry such as Petro-Chemical, environmental technology, off shore, mechanical engineering, power stations and plant construction.

NOMINAL DIAMETER

100 and 160mm

ACCURACY

±1.6% of Full Scale

SCALE RANGE (kpa,Mpa)

0 ~ 1kPa to 0 ~ 40kPa (flange Φ150 mm)

0 ~ 50kPa to 0 ~ 2.5MPa (flange Φ100 mm)

WORKING PRESSURE

Steady : full scale value

Fluctuating : 0.9× full scale value

WORKING TEMPERATURE

Ambient : -20 ~ 65°C

Fluid : +200°C maximum



P771



P772

Standard Features

UPPER DIAPHRAGM FLANGE (Gauge side)

Material : stainless steel (316ss)

DIAPHRAGM MAT'L

≤ 40kPa: stainless steel (316Ti ss)

> 40kPa: Duratherm(NiCrCo-alloy)

PRESSURE CONNECTION AND LOWER FLANGE

Material : stainless steel (316ss,316Lss) and others

Lower mount and flange

CASE & BEZEL RING

stainless steel (304ss)

Bayonet Type

WINDOW

Tempered safety glass

MOVEMENT

stainless steel

DIAL

White aluminium with black graduations

POINTER

Aluminium alloy, Black painted

ORDERING INFORMATION

BASE MODEL

P771 : SCREWED PROCESS CONNECTION DRY TYPE DIAPHRAGM PRESSURE GAUGE
P772 : "I" TYPE FLANGE PROCESS CONNECTION DRY DIAPHRAGM PRESSURE GAUGE

GAUGE MODEL

8A : P252 100A
XA : P252 160A

PROCESS CONNECTION TYPE

XX : Refer to Process Connection Type Table

FLANGE MATERIAL (WETTED PARTS)

B : 304ss
D : 316ss
E : 316Lss
L : 304ss + PTFE coating
M : 304ss + PTFE Lining
N : 316ss + PTFE coating
P : 316ss + PTFE Lining

UNIT

Refer to Pressure Unit & Range Table

RANGE

Refer to Pressure Unit & Range Table

LIQUID FILLING

0 : None
1 : Glycerine filled

OPTION

0 : None
1 : Accessories

P771

8A

ED

D

J

041

0

0

PROCESS CONNECTION TYPE TABLE -7th and 8th Characters

7th Character		8th Character			
Code	Connection Size	For Model P771		For Model P772	
		Code	Connection Type	Code	Flange Rating
*C	1/4"	B	PF	A	JIS 5K RF
*D	3/8"(10A)	C	PT	B	ANSI 150# RF
E	1/2"(15A)	D	NPT	C	ANSI 150# FF
F	3/4"(20A)	F	BSPT	D	ANSI 150# RFSF
G	1"(25A)	G	BSPF	E	ANSI 300# RF
H	1 1/4"(32A)	H	NPS	F	ANSI 300# FF
J	1 1/2"(40A)	J	M	G	ANSI 300# RFSF
K	2"(50A)			H	ANSI 600# RF
L	2 1/2"(65A)			I	JIS 5K FF
M	3"(80A)			J	ANSI 600# FF
N	4"(100A)			K	ANSI 600# RFSF
				L	JIS 10K RF
				M	JIS 10K FF
				N	JIS 10K RFSF
				P	JIS 20K RF
				Q	JIS 20K FF
				R	JIS 20K RFSF
				S	JIS 30K RF
				T	JIS 30K FF
				U	JIS 30K RFSF
				W	JIS 40K RF
				X	JIS 40K FF
				1	ANSI 150# RTJ
				2	ANSI 300# RTJ
				3	ANSI 600# RTJ
Z	Other	Z	Other	Z	Other

***ONLY AVAILABLE WITH MODEL P771**

PRESSURE Unit & RANGE TABLE

Range	Unit & Code	
& Code	J : kPa	I : MPa
105	-50~0	×
104	-40~0	×
001	-30~0	×
103	-25~0	×
002	-20~0	×
003	-15~0	×
004	-10~0	×
005	-6~0	×
006	-5~0	×
007	-4~0	×
008	-3~0	×
010	-1~0	×
076	-30~30	×
074	-20~20	×
073	-15~15	×
071	-10~10	×
014	-5~5	×
018	-3~3	×
020	-2~2	×
022	-1~1	×
023	-0.5~0.5	×
058	0~1	×
061	0~3	×
065	0~4	×
066	0~5	×
067	0~6	×
070	0~10	×
116	0~15	×
117	0~20	×
118	0~25	×
119	0~30	×
121	0~40	×
123	0~50	×
088	0~60	×
041	×	0.1
133	×	0.16
042	×	0.2
134	×	0.25
043	×	0.3
044	×	0.4
045	×	0.6
047	×	1
143	×	1.6
052	×	2.5

○ : AVAILABLE, × : NOT AVAILABLE

P770 : TYPE OF MOUNTING

CODE: P771

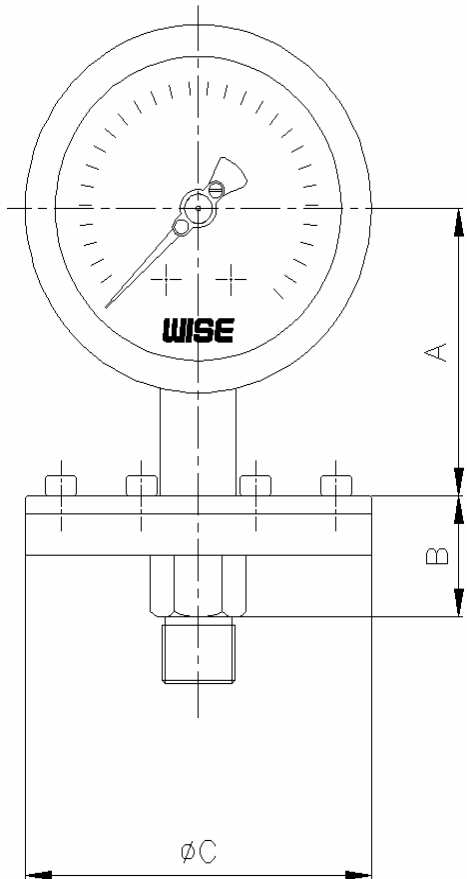

CODE: P772

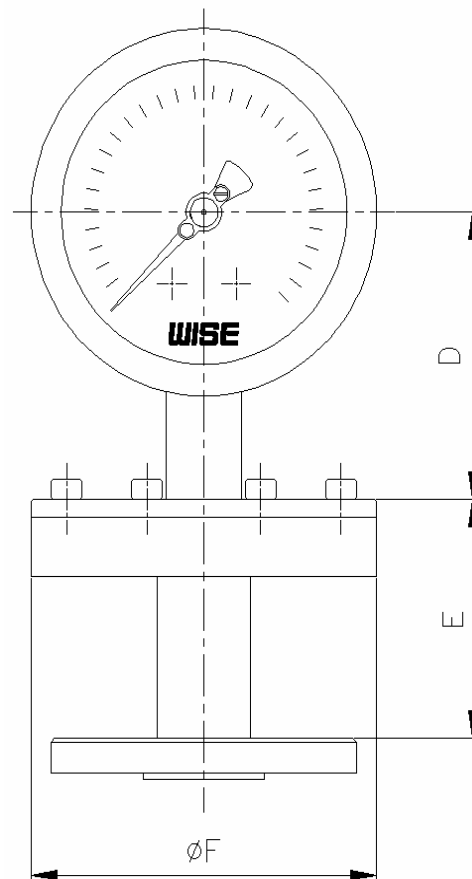

Dial size	Pressure range in kPa	Dimensions in mm					
		A±2	B	C	D±2	E	F
100	≤ 40kPa	78	33	150	78	66	150
100	> 40kPa	78	32	100	78	66	100
160	≤ 40kPa	108	33	150	108	66	150
160	> 40kPa	108	32	100	108	66	100