

GAUGE UNION MODEL : A020



AD01 - 02

SERVICE INTENDED

It is used for positive sealing while the pressure gauge may be directed into any direction

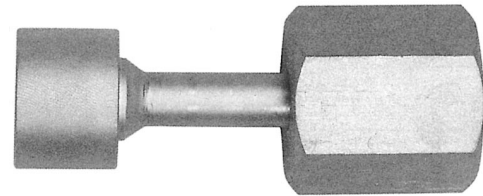

ORDERING INFORMATION

BASE MODEL - 1st thru 4th characters
A020 : GAUGE UNION

5th Character		6th Character		7th Character		8th Character		9th Character	
Code	Union Type	Code	Material	Code	Gauge Connection Size	Code	Gauge Connection Type	Code	Process Connection Size
N	Pipe Welding	B	S25C	0	1/4"	A	PF(F)	A	1/8"(10.5mm)
P	PF(M)	C	304SS	1	3/8"	B	PT(F)	C	3/8"
Q	PT(M)	D	316SS	2	1/2"	C	NPT(F)	D	1/2"
R	Socket Welding	F	316LSS	3	1/8"			E	3/4"
S	Boss	G	Monel					Q	Flange
T	Flange	H	Hastelloy-C						
		Z	Other	9	Other	Z	Other	Z	Other

10th Character		11th Character		12th Character		13th thru 15th Character	
Code	Process Connection Type	Code	Flange Size	Code	Flange Rating	Code	Pipe Length
C	NPT(F)	A	N/A	A	N/A	000	3/8"sch40(17.3 ϕ \times 2.3t), 100mm
G	PF(M)	D	1/2"(15A)	B	ANSI 150# RF	010	3/8"sch80(17.3 ϕ \times 3.2t), 100mm
H	PT(M)	E	3/4"(20A)	C	ANSI 150# FF	020	1/2"sch40(21.7 ϕ \times 2.8t), 100mm
J	NPT(M)	F	1" (25A)	D	ANSI 150# RFSF		1/2"sch80(21.7 ϕ \times 3.7t), 100mm
N	S.W	G	1 1/4"(32A)	E	ANSI 300# RF		
P	Pipe Welding	H	1 1/2"(40A)	F	ANSI 300# FF		
Q	Flange	J	2" (50A)	G	ANSI 300# FFSF		
				H	ANSI 600# RF		
				J	ANSI 600# FF		
				K	ANSI 600# RFSF		
				L	JIS 10K RF		
				M	JIS 10K FF		
				N	JIS 10K RFSF		
				P	JIS 20K RF		
				Q	JIS 20K FF		
				R	JIS 20K RFSF		
				S	JIS 30K RF		
				T	JIS 30K FF		
				U	JIS 30K RFSF		
Z	Other	Z	Other	Z	Other		

Note : Only "P" code 10th character is available when you choose "A" code on 9th character.

A020PC1ACGAA000 SAMPLE ORDERING NUMBER

A020 : GAUGE UNION

AD01 - 02

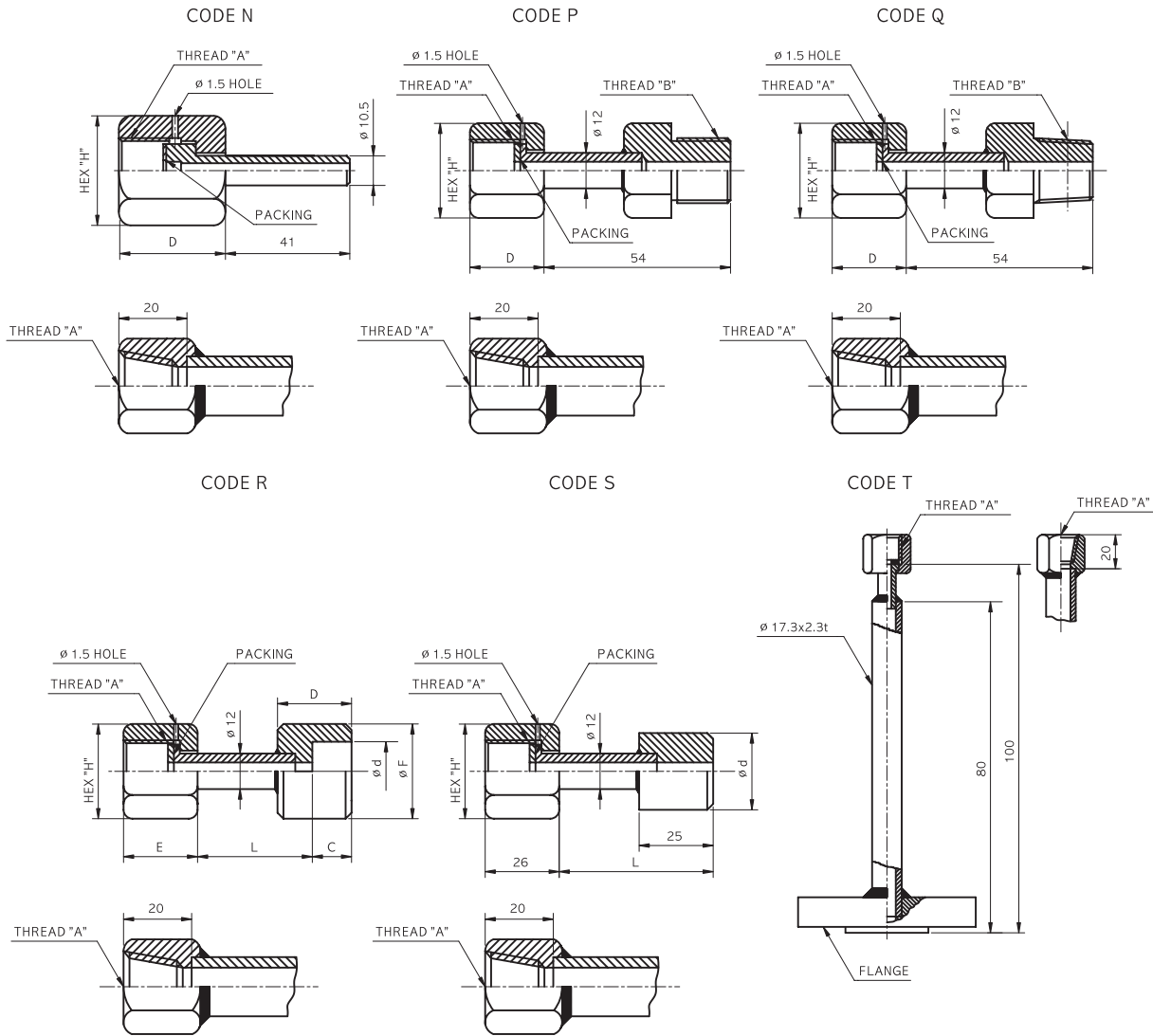

Dimensions (mm)

CODE	A		B	D	H	CODE	A		d	C	D	E	F	L	H		
N	PF	3/8		26	27x31.2	R	PF	3/8	3/8B	10	22	26	26	42	27X31.2		
	(N)PT	1/2	1/2B	32													
P	PF	3/8	(N)PF3/8	26	27x31.2			(N)PT	1/2	3/4B	13		25			28	40
			(N)PF1/2							3/8B							26
			(N)PF3/4				1/2B	10	22	32	42	32X37					
	(N)PT	1/2	(N)PF3/8	28	32x37		PF	1/2	3/8B					45	32X37		
			(N)PF1/2						1/2B								
			(N)PF3/4				3/4B	13	25	40							
Q	PF	3/8	(N)PT3/8	26	27x31.2	(N)PT	1/2	3/8B									
			(N)PT1/2					1/2B									
			(N)PT3/4			3/4B	13	25	40								
	(N)PT	1/2	(N)PT3/8	28	32x37	FLANGE RATING											
			(N)PT1/2			PF	3/8	JIS	10,16,20,	15,20,25,	FF						
			(N)PT3/4			(N)PT	1/2	ANSI	30,40K	32,40,50A	RF						
					PF	3/8	ANSI	150,300,	1/2,3/4,1,	FF							
					(N)PT	1/2	(JPI)	600LB	11/4,11/2,2B	RF							